

## 2.3 Male Branch Tee

### 01. Fractional Tube x NPT (M) Material - **SS 304 | SS 316**

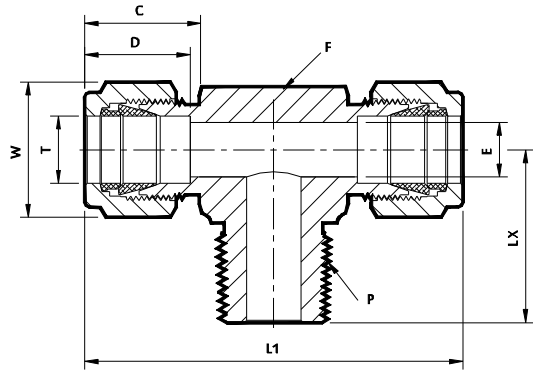

Sr. No.	TUBE OD Ø T	NPT Male Pipe Size P	Ref. Part No.		ØE	D	C	L1	LX	Body Hex F	Nut Hex W
			SS 304	SS 316							
			MBTD4	MBTD6		Dimensions in Inches					
1	1/8 x 1/8		2MBTD2Nx4	2MBTD2Nx6	0.09	0.50	0.60	1.86	0.70	1/2	7/16
2	1/8 x 1/4		2MBTD4Nx4	2MBTD4Nx6	0.09			1.94	0.92	9/16	
3	1/4 x 1/8		4MBTD2Nx4	4MBTD2Nx6	0.19	0.60	0.70	2.12	0.74	9/16	9/16
4	1/4 x 1/4		4MBTD4Nx4	4MBTD4Nx6	0.19			2.12	0.92	9/16	
5	5/16 x 1/8		5MBTD2Nx4	5MBTD2Nx6	0.19	0.64	0.73	2.34	0.82	5/8	5/8
6	5/16 x 1/4		5MBTD4Nx4	5MBTD4Nx6	0.25			2.34	1.01	5/8	
7	3/8 x 1/4		6MBTD4Nx4	6MBTD4Nx6	0.28	0.66	0.76	2.40	1.00	5/8	11/16
8	3/8 x 3/8		6MBTD6Nx4	6MBTD6Nx6	0.28			2.62	1.11	13/16	
9	1/2 x 3/8		8MBTD6Nx4	8MBTD6Nx6	0.38	0.90	0.86	2.84	1.11	13/16	7/8
10	1/2 x 1/2		8MBTD8Nx4	8MBTD8Nx6	0.41			2.84	1.30	7/8	
11	5/8 x 1/2		10MBTD8Nx4	10MBTD8Nx6	0.47	0.96	0.86	3.06	1.41	15/16	1
12	3/4 x 3/4		12MBTD12Nx4	12MBTD12Nx6	0.62	0.96	0.86	3.14	1.45	1.1/16	1.1/8
13	1 x 3/4		16MBTD12Nx4	16MBTD12Nx6	0.62			3.88	1.66	1.3/8	
14	1 x 1		16MBTD16Nx4	16MBTD16Nx6	0.88	1.23	1.04	3.88	1.84	1.3/8	1.1/2

### 02. Metric Tube x NPT (M) Material - **SS 304 | SS 316**

Sr. No.	TUBE OD Ø T	NPT Male Pipe Size P	Ref. Part No.		ØE	D	C	L1	LX	Body Hex F	Nut Hex W
			SS 304	SS 316							
	(mm)	(In)	MMBTD4	MMBTD6		Dimensions in Millimetres					
1	6 x 1/8		6MMBTD2Nx4	6MMBTD2Nx6	4.8	15.3	17.7	53.9	27.0	15	14.2
2	6 x 1/4		6MMBTD4Nx4	6MMBTD4Nx6	4.8			53.9	27.0	15	
3	8 x 1/8		8MMBTD2Nx4	8MMBTD2Nx6	4.8	16.2	18.6	59.7	29.9	15	16
4	8 x 1/4		8MMBTD4Nx4	8MMBTD4Nx6	6.4			59.7	29.9	15	
5	10 x 1/4		10MMBTD4Nx4	10MMBTD4Nx6	7.1	17.2	19.5	67.0	33.5	20.5	19
6	10 x 3/8		10MMBTD6Nx4	10MMBTD6Nx6	7.9			67.0	33.5	20.5	
7	12 x 1/4		12MMBTD4Nx4	12MMBTD4Nx6	7.1	22.8	22.0	72.0	36.0	20.5	22.2
8	12 x 3/8		12MMBTD6Nx4	12MMBTD6Nx6	9.5			72.0	36.0	20.5	
9	12 x 1/2		12MMBTD8Nx4	12MMBTD8Nx6	9.5			72.0	36.0	22.5	
10	16 x 1/2		16MMBTD8Nx4	16MMBTD8Nx6	11.9	24.4	22.0	77.6	38.8	27.5	25.4

- NOTE :
- ① The E Dimension is the minimum opening & Fittings of this group may be back drilling to lager ID at pipe thread or straight thread end
  - ② Dimension L1, C, D is shown in the finger-tight position.
  - ③ NPT thread as per ANSI B 1.20.1.

All part numbers are proprietary of their respective owners, Dimensions are for reference only and are subject to change